

## EASY ROOTER JUNIOR PARTS LIST

CAT. NO.	DESCRIPTION	CAT. NO.	DESCRIPTION
EJ-100-2	Complete Frame w/Heavy Duty Wheel	EJ-201-C	Knob
EJ-101-2	Frame Only (Heavy Duty Wheel)	EJ-204-1	Slip Clutch (See Easy Rooter Diagram ER-204 for Parts Breakdown)
EJ-101-C	Passive Brakes (Rubber Leg Tip (2))	EJ-205	20' Power Cord w/Plug & GFCI
EJ-101-D	Cord Wrap Cap (2)	EJ-207	Air Foot Switch and Rev. Switch Assembly
EJ-102	8" Rubber Wheel (1)	EJ-207-A	Box Only with Cover & Screws
EJ-102-1	10" Rubber Wheel (1)	EJ-207-B	Foot Pedal & Hose
EJ-102-2	10" Rubber Wheel (1) (10" Mag Wheel)	EJ-207-C	Hose Clamp (2)
EJ-103	Axle (10" Wheel)	EJ-207-D	Foot Pedal
EJ-103-A	Wheel Caps (2)	EJ-207-E	Power Switch Diaphragm
EJ-103-B	Axle Spacers (2)	EJ-207-F	Air Hose
EJ-103-1	5/8" Axle (10" Mag Wheel)	EJ-207-G	Reverse Switch Only (3-Way)
EJ-103-1-A	Wheel Caps for 5/8" Axle (2)	EJ-207-G-R	Momentary Contact Reverse Switch Only (Red)
EJ-103-1-B	Axle Spacers (2)	EJ-207-H	Rubber Switch Boot
EJ-105	Handle with Knobs	EJ-207-K	Switch Guard
EJ-105-A	Handle Locking Knob (2)	EJ-208	V-Belt (47")
EJ-106	Brake Rod	EJ-209	Motor Support Spring
EJ-106-A	Roll Pin (1/8" x 1")	EJ-211	Belt Guard w/Velcro
EJ-107	Brake Rod Handle w/Knob	EJ-211-2	Belt Guard w/Slot for Stud
EJ-107-A	Plastic Knob	EJ-212	Motor Support Bracket with Guide Screws
EJ-107-B	Axle Retaining Pin (1/8" x 5/8")	EJ-212-A	Guide Screws (2)
EJ-107-C	Brake Rod Latch w/Screws	EJ-213	Nuts, Bolts, Washers (4)
EJ-108	Drum Support Shaft	EJ-300	Cage with Hub and Bearings
EJ-109	Bronze Thrust Washer	EJ-302	Cage Hub with Bearings
EJ-110	Felt Washer	EJ-302-A	Cage Hub Bearings (set)
EJ-111	Drum Hub Retaining Washer	EJ-302-C	Bolts & Lock Washers (12)
EJ-112	Drum Shaft Retaining Bolt	EJ-303	Cable Locking Thumb Screw
EJ-116	Screws & Washers (2)	EJ-DECAL	Set of Safety Decals
EJ-120	Cutter Holder	EJ-VIDEO	Instructional DVD
EJ-121	Tool Holder Screws & Washers (2)		
EJ-201	1/3 hp Capacitor Motor Complete w/Air Foot Switch, Rev. Switch Assembly, & GFCI		

# EASY ROOTER JUNIOR SCHEMATIC DIAGRAM

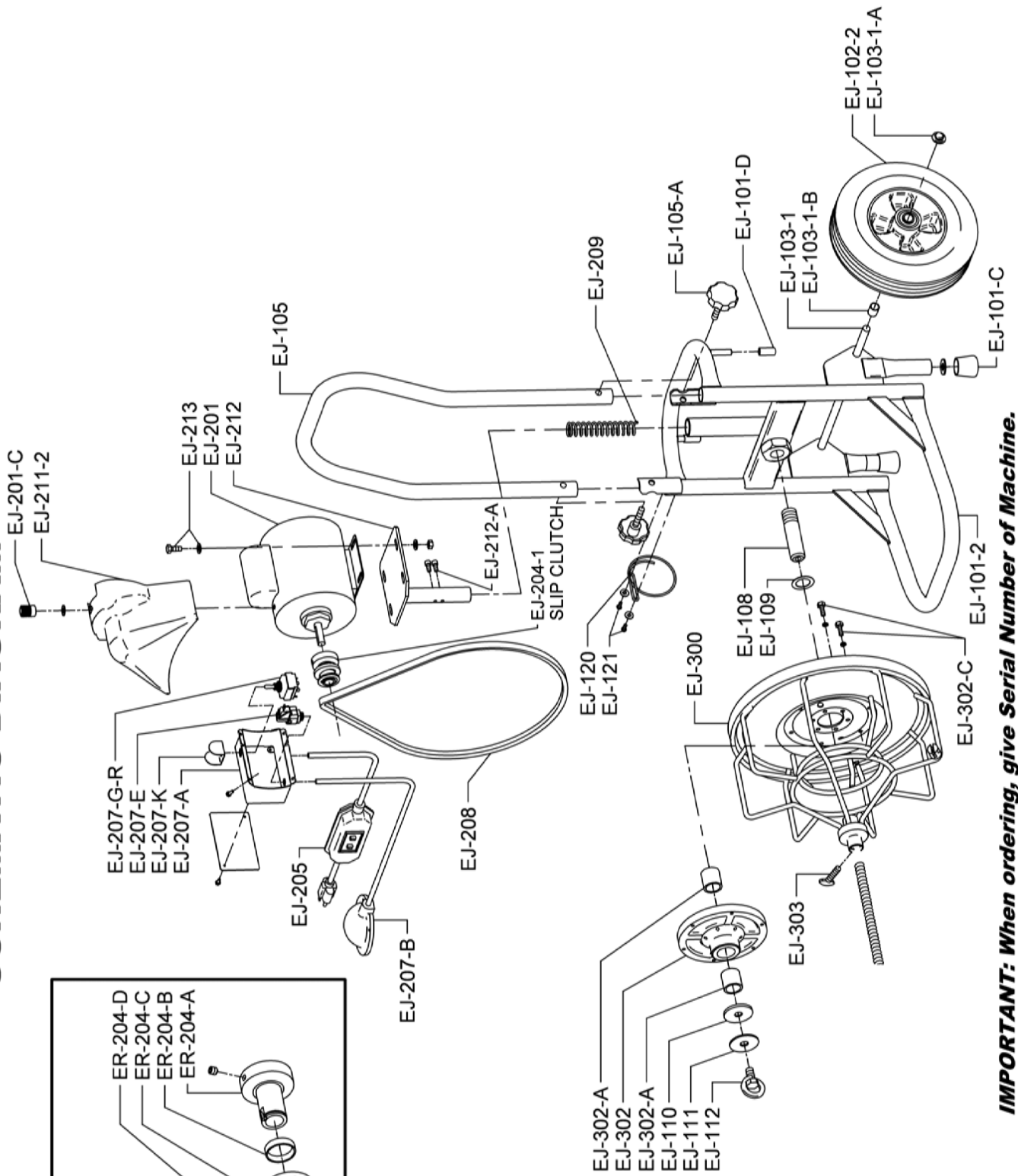
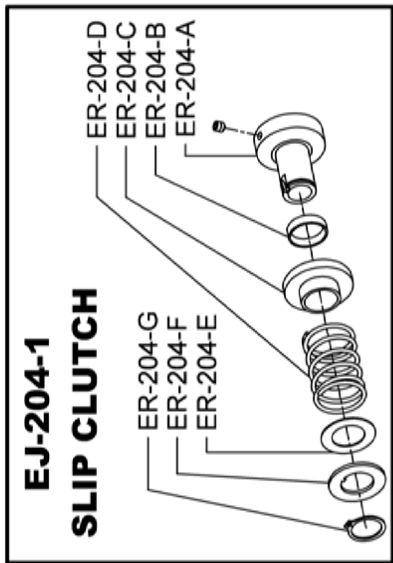

**IMPORTANT: When ordering, give Serial Number of Machine.**